

REV	DATE	DESCRIPTION	ECN NO.	NAME
A	07.02.05	NEW RELEASE		Yangxf

# G6174-50 SERIES MICRO SD(TRANS FLASH) CARD SOCKET PUSH/PUSH TYPE -CUSTOMER DRAWING

A  
B  
C  
D  
E

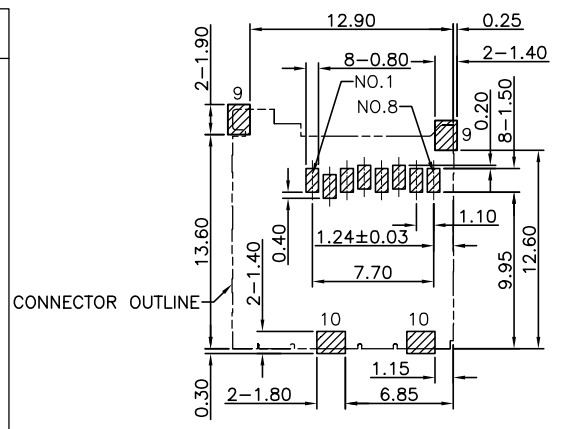
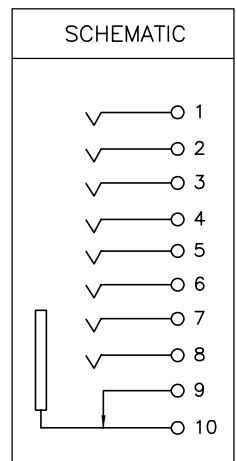
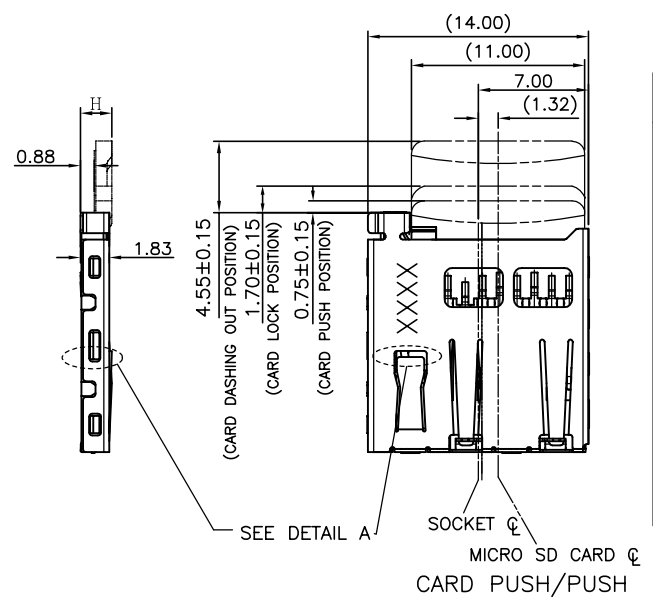
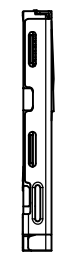
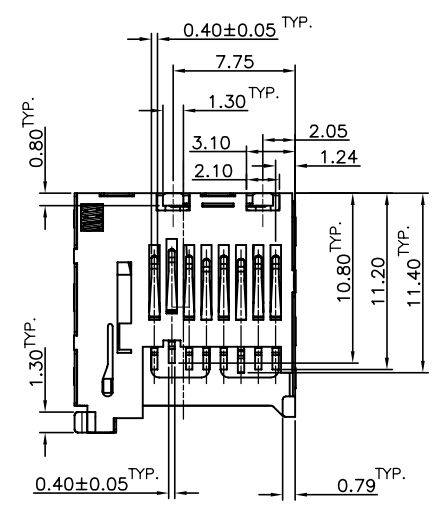

RECOMMENDED PCB PATTERN LAYOUT  
TOLERANCE: ±0.05

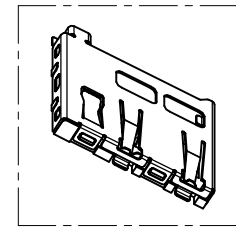
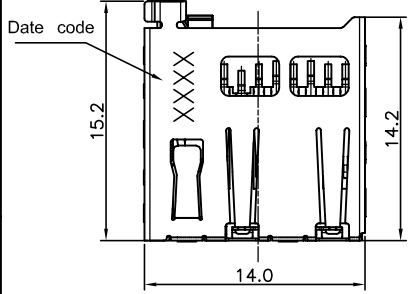
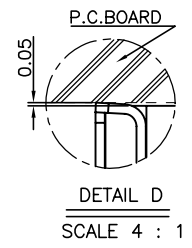
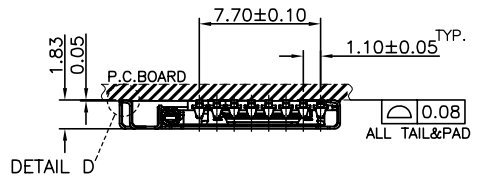

3D VIEWS

RELATION OF SWITCHES TO MICRO SD(TRANS FLASH) CARD ATTACHMENT CONDITION

CARD ATTACHMENT CONDITION	CARD DETECT SWITCH	SITUATION DEPICTION
CARD NOT ATTACHED	CLOSED	9&10 SHORT
CARD ATTACHED	OPEN	9&10 OPEN

Pin No.	Name	Type	DESCRIPTION
1	DAT2	I/O/PP	Data Line [bit2]
2	CD/DAT3	I/O/PP	Card Detect Data Line [bit3]
3	CMD	PP	Command Response
4	VDD	S	Supply Voltage
5	CLK	I	Clock
6	VSS	S	Supply Voltage Ground
7	DAT0	I/O/PP	Data Line [bit0]
8	DAT1	I/O/PP	Data Line [bit1]

NOTE:H=1.98mm為產品下底部到夾卡台階上表面距離。

GENERAL TOLERANCE ±0.25mm	WIESON TECHNOLOGIES CO., LTD WIESON	PART NO.: G6174-5000****-00	
		DRAWN BY Yangxf(WSC)	DRAWING NO. G6174-500
GENERAL ANGLE TOLERANCE ±3°	CHECKED BY KEVIN	DRAWING SIZE 1 : 1 A4	
	APPROVED BY JERRY	UNIT mm	
	SORTING NO. (WSC)	PAGE 1 OF 2	

已發行

G6174-50 SERIES MICRO SD(TRANS FLASH) CARD SOCKET  
 PUSH/PUSH TYPE -CUSTOMER DRAWING

REV	DATE	DESCRIPTION	ECN NO.	NAME
A	07.02.05	NEW RELEASE		Yangxf

- MATERIAL :  
 INSULATOR:HIGH TEMPERATURE THERMOPLASTIC. UL94V-0.  
 CONTACT:COPPER ALLOY.  
 SHELL:STAINLESS STEEL.  
 DETECT PIN:COPPER ALLOY.  
 COIL SPRING: STAINLESS STEEL.  
 CRANK AXLE:STAINLESS STEEL.  
 SLIDE:HIGH TEMPERATURE THERMOPLASTIC. UL94V-0.  
 LOCK PIN:STAINLESS STEEL.
- PLATING :  
 CONTACT: SEE ORDER INFORMATION  
 DETECT PIN: 1u" min. Au PLATED  
 SHELL:1u" min. Au IN SOLDER TAIL AREA.
- ELECTRIACL CHARACTERISTIC:  
 CONNECT RESISTANCE:40 MILLIONMS/PIN Max.  
 INSULATION RESISTANCE:1000 MEGAOHMS Min.  
 VOLTAGE WITHSTAND:500V AC for 1minute
- MECHANICAL CHARACTERISTIC:  
 CONTACT MATING FORCE:3Kgf Max.  
 CONTACT UNMATING FORCE:100gf Min.  
 CYCLE LIFE:10000 TIMES
- USE INFORMATION

This socket use in the organ that is 2.0min millimeters high, And the inserted Card will touch terminals first,then the detect pin.

ORDER INFORMATION

G6174-50 0001 \*\* -00

- 01: 15u" min. Au IN CONTACT AREA, Sn IN SOLDER TAIL AREA.
- 02: 15u" min. Au PLATED
- 03: 10u" min. Au IN CONTACT AREA, Sn IN SOLDER TAIL AREA.
- 04: 10u" min. Au PLATED
- 05: 5u" min. Au IN CONTACT AREA, Sn IN SOLDER TAIL AREA.
- 06: 5u" min. Au PLATED

CARD DETECT SWITCH

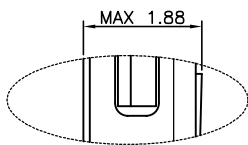
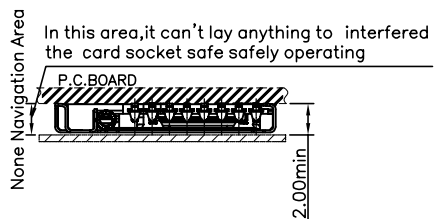
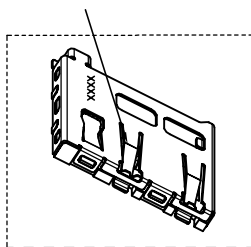

DETAIL A  
 SCALE 4 : 1  
 CARD PUSH POSITION

GENERAL TOLERANCE ±0.25mm GENERAL ANGLE TOLERANCE ±3°	WIESON TECHNOLOGIES CO., LTD		PART NO.: G6174-5000****-00	
	DRAWN BY	Yangxf(WSC)	DRAWING NO.	G6174-500
	CHECKED BY	KEVIN	DRAWING SIZE	1 : 1   A4
	APPROVED BY	JERRY	UNIT	mm
⊕	SORTING NO.	(WSC)	PAGE	2 OF 2

已發行